

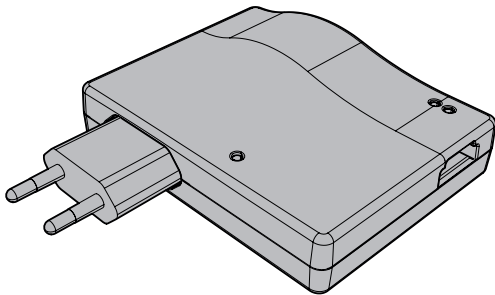

# SOMlink



**Manual**

# Contents

<b>Notes.....</b>	<b>3</b>	Preparing the SOMlink for operation....	13
Notes on the correct use of the SOMlink3			
<b>Legal information .....</b>	<b>4</b>	<b>Standard mode .....</b>	<b>14</b>
Intended use .....	4	Establishing connection with the SOMlink .....	14
Improper use .....	4	Accessing the user interface via the browser .....	15
Simplified Declaration of Conformity .....	4	Accessing the user interface via the app (up to Android Version 8) .....	15
Links.....	5	<b>Hotspot mode .....</b>	<b>18</b>
FCC / IC Statement (USA / Canada) .....	5	Establishing connection via the APP (for Android devices) .....	18
<b>Product information .....</b>	<b>6</b>	Establishing connection to a Windows hotspot .....	22
Functional description .....	6	Accessing the user interface via the browser .....	24
Compatibility .....	6	<b>User interface.....</b>	<b>25</b>
Connection modes .....	7	Home page .....	25
<b>Technical information .....</b>	<b>9</b>		
Technical data .....	9		
Interfaces and LEDs .....	10		
Flashing codes .....	11		
<b>Scope of delivery.....</b>	<b>12</b>		
<b>Initial operation.....</b>	<b>13</b>		

# Notes

## Notes on the correct use of the SOMlink



### **NOTE**



- Use only in dry rooms
- Clean only with a dry cloth
- Dispose of the unit in accordance with local regulations

# Legal information

## Intended use

With SOMlink intelligent control technology, there are additional options for adjusting features and parameters with a web app using a smartphone, tablet PC or laptop. Communication between the SOMlink and the operators takes place via a radio connection. Settings are made and information is read out within the user interface .

## Improper use

Any use above and beyond that listed in the section "Intended use" is deemed to be improper.

Opening the housing and modifications to the hardware are also deemed to be improper use.

## Simplified Declaration of Conformity

SOMMER Antriebs- und Funktechnik GmbH hereby declares that the radio system of type Pearl SOMlink complies with Directive 2014/53/EU. The full text of the EU Declaration of Conformity can be found at the following internet address:



[www.som4.me/mrl](http://www.som4.me/mrl)

# Legal information

## Links

SOMMER website

[www.sommer.eu](http://www.sommer.eu)

Installation and Operating Manuals

[www.som4.me/man](http://www.som4.me/man)

SOMMERsuite

[www.som4.me/sommersuite](http://www.som4.me/sommersuite)

## FCC / IC Statement (USA / Canada)

**Item No.: S10683-00001 / 922.5 MHz**

This device complies with FCC rules part 15. The operation of this device is subject to the following conditions:

- 1) This device may not cause harmful interference, and
- 2) This device must accept any interference received, including interference that may cause undesired operation!

# Product information

## Functional description

With SOMlink intelligent control technology, there are additional options for easily adjusting features and parameters with a web app using your smartphone, tablet PC or laptop.

**As all data are processed and saved in the SOMlink and the additional memory, Memo there is no data transmission to external servers.**

## Compatibility

A list of compatible products can be viewed online at:

[som4.me/somlinkservice](http://som4.me/somlinkservice)



# Product information

## Connection modes

In principle, there are two ways to establish a connection between the SOMlink and an end device, see Chapter “**Mode overview**” on page 8:

### 1. Standard mode

The user logs in to the WiFi provided by the SOMlink using a smartphone/tablet or PC. The network name (SOMlink+MAC address) and network key (key icon) are printed on the back of the SOMlink. The user interface can then be accessed via the browser (<https://somlink.lokal>) or the Android app of the end device.

- Make sure that the SOMlink is not already connected to a hotspot.
- For standard mode, no adjustment of the smartphone/tablet settings is necessary .
- If there are connection problems in standard mode, it is possible to switch to hotspot mode.

# Product information

## 2. Hotspot mode

The SOMlink logs in to the mobile hotspot of the smartphone/tablet/PC.

- Hotspot mode is available for all Android versions and Windows 10 .
- For hotspot mode, the settings for the mobile hotspot of the smartphone/tablet/PC must be adjusted under Android and Windows as described starting on **Page 18**. The necessary information is printed on the back of the SOMlink.
- The smartphone/tablet or PC can still be used as a mobile hotspot for other applications.  
– *It is important to note here that for each end device, the new SOMlinklogin data are needed to log in to the mobile hotspot.*
- The user interface can then be accessed via the browser (somlink.mshome.net) or the Android app of the end device.

### Mode overview

Standard mode	Hotspot mode
Browser (all end devices)	Browser (Windows 10)
Android app (up to and including Android Version 8)	Android app (all versions)
Apple iOS	



# Technical information

## Technical data

### Power supply input

Rated voltage	100–240 V
Rated frequency	50–60 Hz

### Power supply output

Rated voltage	5 V
Rated current	1 A

### SOMlink input

Rated voltage	DC 5 V
Rated current	1 A

### Further data

Dimensions (without power supply unit)	102 x 80 x 28 mm
WiFi standard	2,4 GHz

# Technical information

## Interfaces and LEDs

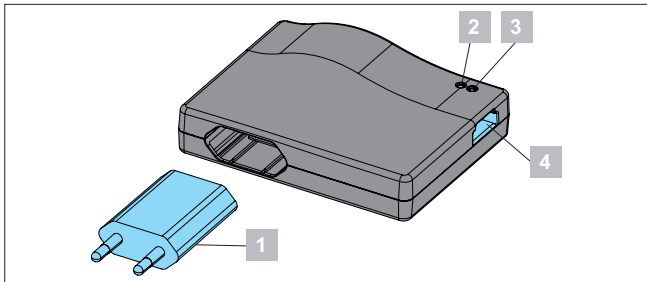

**1** Power supply unit







**2** Status LED

**3** WiFi LED

**4** Memo slot

# Technical information

## Flashing codes

Status LED	Meaning
Lights up red 	No operator, radio receiver or Memo connected
Lights up green 	Operator, radio receiver or Memo is connected
WiFi LED	Meaning
Lights up green 	Connected to WiFi
Blinks green 	Device communicating via WiFi
Lights up red 	No WiFi connection
Blinks red 	Attempt to connect hotspot mode

# Scope of delivery

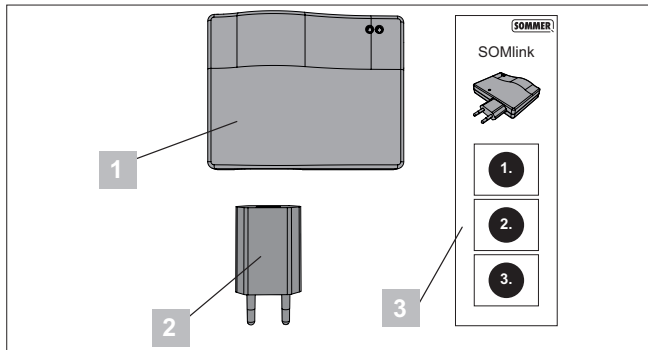

1

SOMlink

2

Power supply unit

3

Brief instructions

# Initial operation

## Preparing the SOMlink for operation

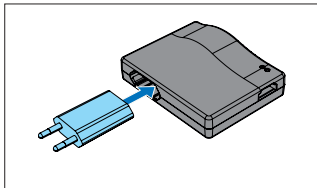

1. Connect SOMlink and power supply unit.

### **TIP**

So that you have the data to hand for later entry, make a note of the MAC address and the WiFi password printed on the back of the device before plugging the SOMlink in.

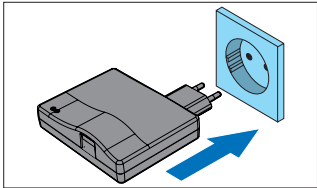

2. Switch on voltage supply.  
⇒ Check whether WiFi LED lights up red

# Standard mode

## Establishing connection with the SOMlink

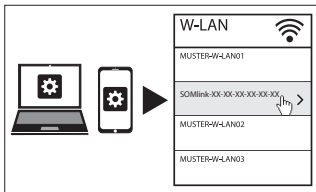

1. Open the network options menu of the end device.  
⇒ The WiFi network of the SOMlink is displayed in the list. The network name comprises the word **"SOMlink"** and the MAC address of the device
2. Select the WiFi network.

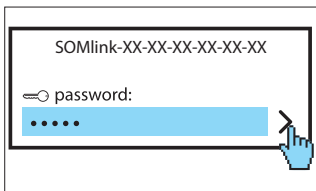

3. Enter the password you have noted down and confirm; see **Page 13**.  
⇒ WiFi LED switches from red to green

# Standard mode

## Accessing the user interface via the browser

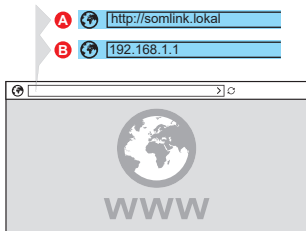

4. Open the browser on the end device and access the SOMlink user interface.

⇒ **Option A:**

Enter **http://somlink.lokal** in the address line and confirm

⇒ **Option B:**

Enter **192.168.1.1** in the address line and confirm

### ➔ **TIP**

- ▶ If you create a bookmark in the browser, you will be able to access the user interface more quickly in future.

## Accessing the user interface via the app (up to Android Version 8)

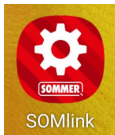

1. Open the SOMlink app on the tablet or smartphone.



**App download**

<https://play.google.com/store/apps/details?id=sommer.somlink>

# Standard mode



Willkommen bei **SOMlink**  
Wie möchten Sie die Verbindung herstellen?

STANDARD-MODUS

HOTSPOT-MODUS

2. Select **"Standard mode"** and tap **"Start"**.



## Mit Stromversorgung verbinden

Um das Gerät einzuschalten, verbinden Sie es mit der Stromversorgung. **Wenn das Gerät bereits eingeschaltet ist, zuerst Netzstecker ziehen!**

3. Follow the instructions on the screen.



# Standard mode

WLAN-Verbindung zum Gerät herstellen

WLAN-SCAN STARTEN

WLAN-Verbindung zum Gerät herstellen

WLAN-SCAN STARTEN

SOMlink-XX-XX-XX-XX-XX-XX

4. Tap "**START WIFI SCAN**".
5. Select desired SOMlink Wifi.

# Hotspot mode

## Establishing connection via the APP (for Android devices)



### NOTE

Precondition: SOMlink app has been downloaded from the Google Play Store and installed.



1. Open the SOMlink app on the tablet or smartphone.



App download

<https://play.google.com/store/apps/details?id=sommer.somlink>



Willkommen bei SOMlink!

Stellen Sie sicher, dass auf Ihrem SOMlink die neueste Firmware installiert ist. Aktualisieren Sie bei Bedarf die Firmware Ihres SOMlink mit **SOMMERsuite** auf einem Windows-PC.

START

2. Tap "**Start**" to continue.

# Hotspot mode

**Hotspot-Name (SSID):**  
SOMlink + letzte 4 Zeichen der  
MAC-Adresse

**Hotspot-Passwort:**  
Letzte 4 Zeichen der MAC-Adresse +  
aufgedruckter Code

*Beispiel:*



HOTSPOT-EINSTELLUNGEN ANZEIGEN

3. Tap **"OPEN HOTSPOT SETTINGS"**  
to set up the hotspot on the device as  
shown in the illustration.

- ⇒ The SOMlink app closes and the device switches to the settings screen.
- ⇒ The data required for configuration can be read off on the back of the SOMlink.

- ⇒ It is important to pay attention to the correct spelling (upper case/lower case) when setting up the hotspot.
- ⇒ The device requests confirmation that you wish to switch off the WiFi.

# Hotspot mode

Example:

Hotspot settings of smartphone/tablet

Type plate SOMlink

The diagram illustrates the configuration of a mobile hotspot. On the left, a 'Type plate SOMlink' displays the following information: 'SOMlink', '7040000', 'MAC Address: 00-21-E2-00-1C-63', a key icon with '25564', and '868,950 MHz'. On the right, the 'Mobile Hotspot-Konfiguration' screen shows: 'Netzname' set to 'SOMlink 1C63', 'Sicherheit' set to 'WPA2 PSK', and 'Passwort' set to '1C6325564'. Red lines connect the '1C63' from the MAC address to the network name and password, and the '25564' from the key icon to the password.

SOMlink

7040000

MAC Address: 00-21-E2-00-1C-63

25564

868,950 MHz

Mobile Hotspot-Konfiguration

Netzname

SOMlink 1C63

Mein Gerät ausblenden

Sicherheit

WPA2 PSK ▼

Passwort

1C6325564

Geben Sie ein Passwort mit mindestens 8 Zeichen ein

Erweiterte Optionen anzeigen

Abbrechen | Speichern

4. Configure and save.
5. Return to the SOMlink app.

# Hotspot mode



## Mit Stromversorgung verbinden

Um das Gerät einzuschalten, verbinden Sie es mit der Stromversorgung. **Wenn das Gerät bereits eingeschaltet ist, zuerst Netzstecker ziehen!**



## LED-Anzeige prüfen

Leuchtet die obere LED kontinuierlich grün? Wartezeit bis zu 20 Sekunden.

JA

NEIN

6. Follow the instructions on the screen to complete installation.
  - ⇒ If the LED does not blink green after 20 seconds as described, return to the hotspot settings and enter the correct password; see **Page 20**.

# Hotspot mode

## Establishing connection to a Windows hotspot

The following section describes the existing standard settings for Windows 10.

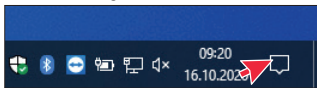

1. Open the Infocenter (see illustration – mouse pointer)

⇒ The screen below opens

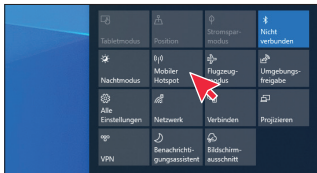

2. Right-click "Mobile hotspot".

⇒ The Characteristics window opens

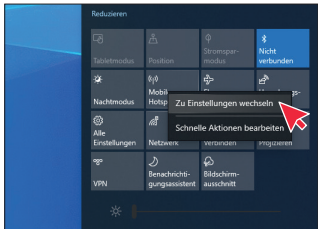

3. Click the window "Go to Settings".

⇒ The Settings window of the mobile hotspot opens



# Hotspot mode

- Network name: (Example: see illustration)
- Network password: (Example: see illustration)
- Network band: (always 2.4 GHz)

⇒ Check and save your entries

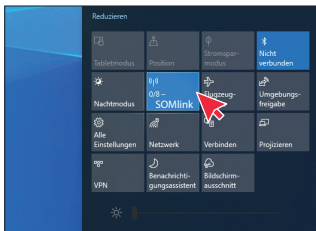

6. Activate the mobile hotspot in the Infocenter – left-click the button "**Mobile hotspot**".

⇒ On activation, the button is highlighted in blue, and the previously assigned hotspot name is displayed

## Accessing the user interface via the browser

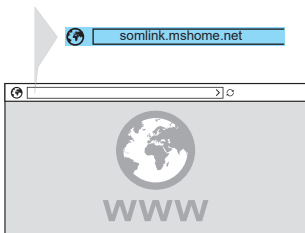

1. Open the browser on the end device and access the SOMlink user interface.

⇒ Enter **somlink.mshome.net** in the address line and confirm

### TIP

- ▶ If you create a bookmark in the browser, you will be able to access the user interface more quickly in future.



# User interface

## Home page

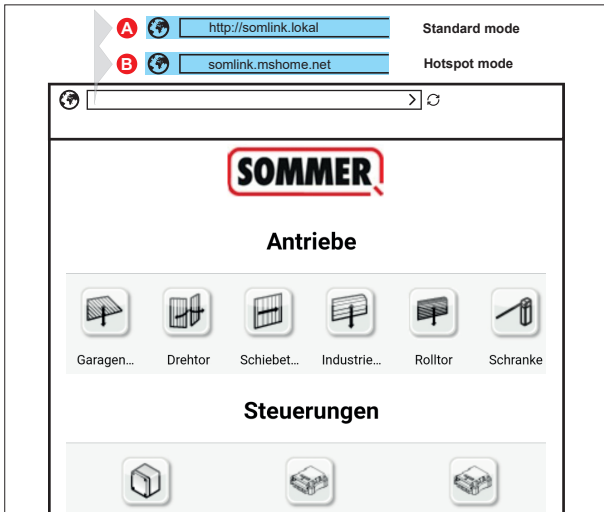

⇒ The SOMlink user interface is loaded after successful installation.

✓ SOMlink is ready for operation

## **SOMMER Antriebs- und Funktechnik GmbH**

Hans-Böckler-Straße 27

73230 Kirchheim/Teck

Germany

[info@sommer.eu](mailto:info@sommer.eu)

[www.sommer.eu](http://www.sommer.eu)

© Copyright 2021 All rights reserved.